

HANGER BEARINGS

For Screw Conveyors

SCREW CONVEYOR HANGER BEARINGS

STYLE "A" BEARING: STYLE 226

Two-piece double flange bearing for screw conveyor hanger with formed strap. This hanger bearing is interchangeable with the following styles: 20A, 20B, 26B, 28A, 30, 50, 220, 226 228 and 326.



STYLE A: DIMENSIONS				
A	B	C	D	E
1-1/2	2-3/16	2-1/2	1-7/8	1-9/16
2	2-3/4	3-1/8	1-15/16	1-9/16
2-7/16	3-1/4	3-11/16	2-15/16	2-3/8
3	4	4-3/8	2-15/16	2-1/4
3-7/16	4-3/4	5	3-3/16	3-1/16

* Tolerances: + 1/16" / - 0"

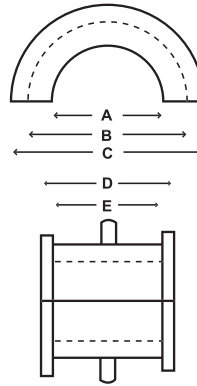
Other sizes available on request. Hanger strap not included.



AVAILABLE MATERIALS

	PLASTECH	WEARITE*	UHMW
MAXI-LIFT HANGER BEARINGS			
MATERIAL	Engineered Nylon Resin	Engineered Nylon Resin	Polyethylene
GRADE	Food Grade, FDA	Industrial Grade	Food Grade, FDA
METHOD OF MANUFACTURE	Injection Molded	Injection Molded	Machined Or Molded
TEMPERATURE OPERATING RANGE	-60°F To +300°F	-60°F To +300°F	-22°F To +180°F
LUBRICANT	Built-In Lubricant	Built-In Lubricant*	Natural
COLOR	Tan	Black	White

* Wearite bearings available drilled and tapped for lubing or purging pipes at additional cost.